



MAGNUM KNUCKLES INSTALLATION GUIDE

INCLUDED:

- (1) Left Magnum Outer Knuckle
- (1) Right Magnum Outer Knuckle
- (4) Tapered Roller Bearings
- (2) Trunnion Pins
- (2) Magnum Inner C's
- (2) Magnum High Steer Arms
- (2) Kingpin Caps
- Hardware Kit

TRUNNION PIN TO HIGH STEER ARM ASSEMBLY

Coat the steering trunnion with anti-seize and screw it into the High Steer arm. Ensure the keyway is coated with anti seize so that it will not rust. Once installed and coated, set aside.



ASSEMBLY INTO THE INNER C

Install the bearing and races, seals and dust caps into the C as pictured. Take note of where to add silicone sealant to the parts to make sure you have a water tight assembly when everything is final assembled.

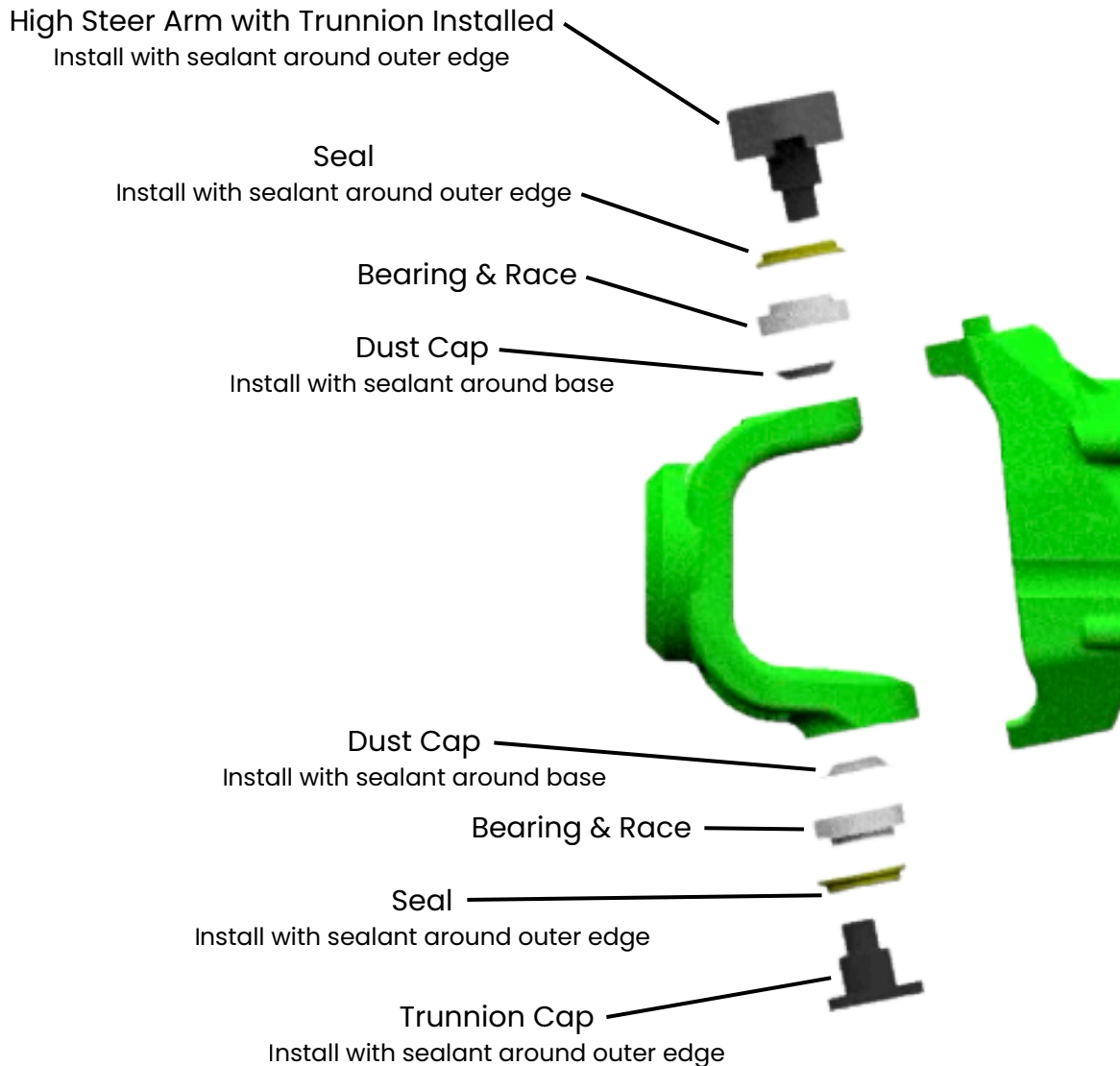

After you have the knuckle assembled to the C, preload needs to be set on the top trunnion pin. Torque the pin to 75 Ft/LBS and then lock the jam nut. Make sure that there is some resistance when you turn the knuckle left to right.

Install the grease fittings on the top and bottom trunnion pins and then add grease through them to the top and bottom bearings.